

232,229 SF

Industrial Space For Lease



Prologis Vernon Business Center

5215 S. Boyle Avenue, Building 2
Vernon, CA 90058 USA



LOCATION

- Central Los Angeles County Location
- Excellent Access to Major Freeways, Downtown Los Angeles, and the Ports of Los Angeles and Long Beach

FACILITY

- Brand New Class "A" Prologis Development
- 10,395 SF Corporate Offices
- 36' Clearance
- E.S.F.R. K25 40 PSI Sprinklers
- 38 Dock High Doors/54 Trailer Stalls
- 180' Turning Radius/100% Concrete Truck Court
- 2 Ground Level Ramps
- Fenced Yard Possible
- 60' Staging Bay & 50' x 56' Column Spacing
- 184 Car Parking (More Possible)
- 2,000 Amps (4000 Possible)
- White Scrim Foil/Painted Warehouse Walls
- 8" Concrete Warehouse Slab
- 2.5% Skylights

ADVANTAGES AND AMENITIES

- City of Vernon "Exclusively Industrial"
- No Gross Receipts Tax
- Low Business License Fees
- Consistently Low Vernon Utility Rates

232,229 SF

Industrial Space For Lease

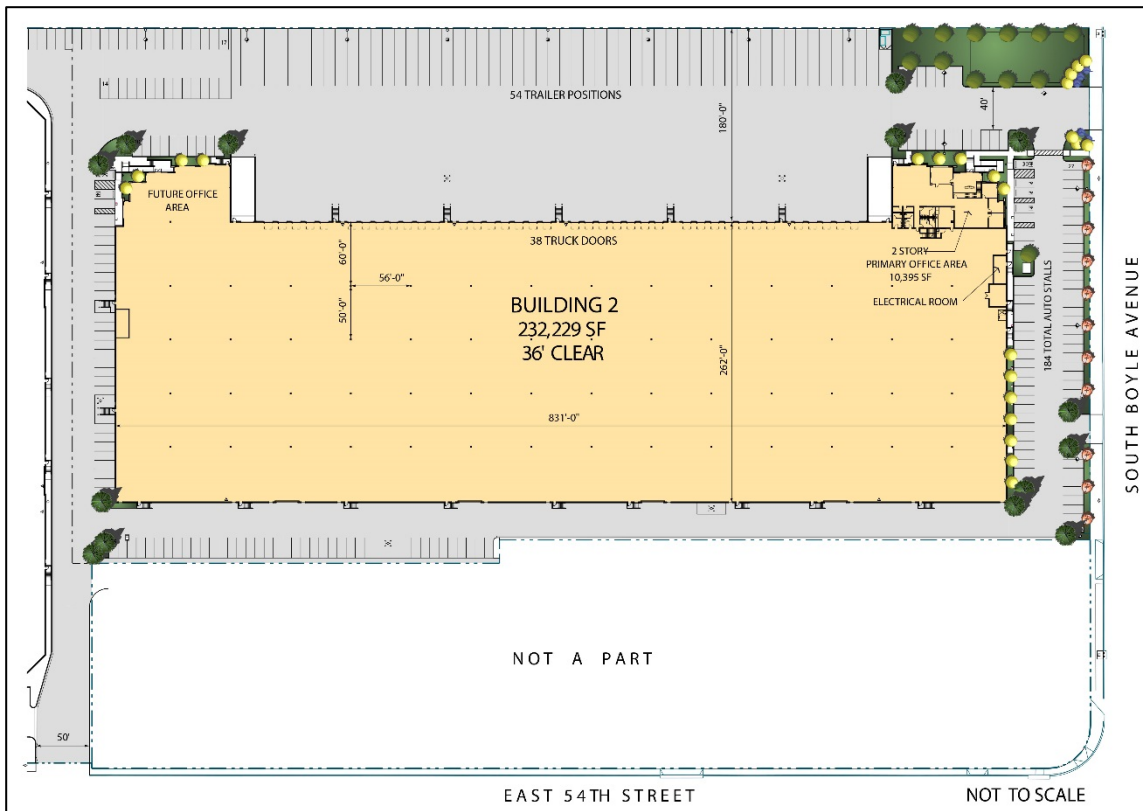
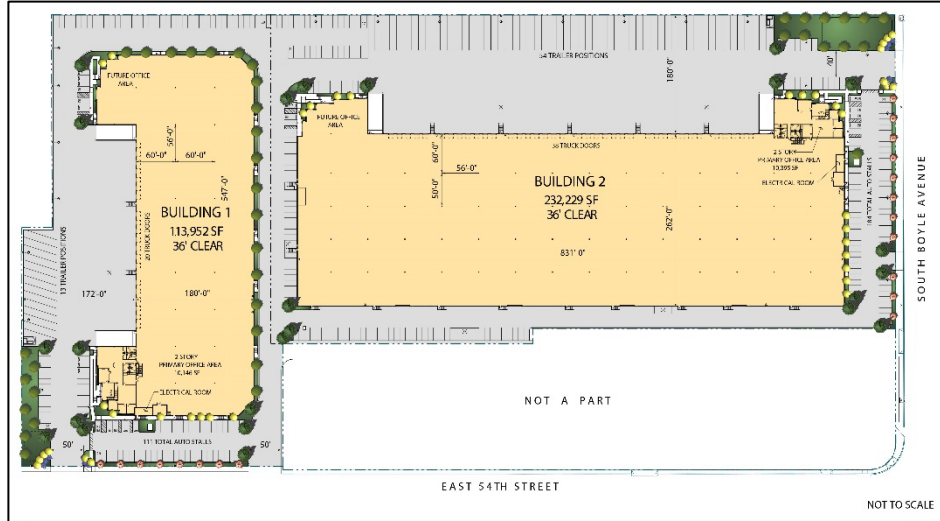

Newmark Knight Frank

John McMillan

CalDRE License #01103292
john.mcmillan@ngkf.com
ph +1 310 491 2048
2301 Rosecrans Avenue
Suite 4100
El Segundo, CA 90245 USA

Newmark Knight Frank

Jeff Sanita

CalDRE License #01242202
jeff.sanita@ngkf.com
ph +1 310 491 2003
2301 Rosecrans Avenue
Suite 4100
El Segundo, CA 90245 USA

Newmark Knight Frank

Greg Stumm

CalDRE License #01954921
greg.stumm@ngkf.com
ph +1 310 491 2003
2301 Rosecrans Avenue
Suite 4100
El Segundo, CA 90245 USA

Prologis

Lisa Reddy

CalDRE License #01327922
lreddy@prologis.com
ph +1 562 345 9206
2141 Rosecrans Avenue
Suite 1151
El Segundo, CA 90245 USA

Prologis

Analise Guttman

CalDRE License #01966053
aguttmann@prologis.com
ph +1 562 345 9239
2141 Rosecrans Avenue
Suite 1151
El Segundo, CA 90245 USA